

- Dry ceramic sensor
- Ranges from 100 mbar to 300 mbar
- Accuracy $\leq 0,5\%$
- Compact and rugged design
- For large variety of applications
- Processconnect G $\frac{1}{2}$ A, 11,5 mm Bohrung
- Connector or Cable output
- Analog output: 4...20 mA, 2-wire



OEM Pressure Transmitter P 115

Technical data:

| | |
|------------------------|---|
| Pressure range: | 0...100 mbar up to 0...300 mbar |
| Output: | 4...20 mA, 2-wire |
| Accuracy: | $\leq \pm 0,5\%$ FS @ 25°C |
| Response time: | 200 ms (other on request) |
| Power supply: | 9...30V DC |
| Ambient Temperature: | -25...80 °C |
| Process Temperature: | -25...100 °C |
| Temperature coeff.: | $\leq \pm 0,03\%$ FS/K (zero) $\leq \pm 0,02\%$ FS/K (span) |
| Long term stability: | $\leq \pm 0,5\%$ FS p. a. |
| Process Connection: | Stainless Steel 1.4404 |
| Housing: | Stainless Steel 1.4404 |
| Sensor: | Ceramic AL ₂ O ₃ |
| Electrical Connection: | Connector EN 175301-803A, IP67 Connector M12, IP 67 Quickon-Connector, IP 67 Cable connection, IP 67 |

Nöding

Meßtechnik

| Range | Gauge | Overload (bar) |
|--------------|-------|----------------|
| 0...100 mbar | 00 | 1 |
| 0...160 mbar | 01 | 1 |
| 0...200 mbar | B1 | 1 |
| 0...250 mbar | 02 | 1 |
| 0...300 mbar | X5 | 1 |

Output Signal

4 4...20 mA 2-wire

Range

Measure range
99 non standard range

Processconnect and Material

G G 1/2 A u. 11,6 mm bore hohle 1.4404
9 others (on request)

Sensor Seal

1 FPM (Viton) Standard
2 NBR (Perbuan)
3 EPDM-Kautschuk
9 others (on request)

Electrical Connection

0 5m cable, IP 67
1 Connector EN 175301-803A IP67
6 2m cable IP 67
A Connector M12x1, IP 67
F Quickon-Connector IP 67
H 10m Cable, IP 67
9 others (on request)

Pottet Electronic

0 non
1 pottet electronic



Dimensions (mm)

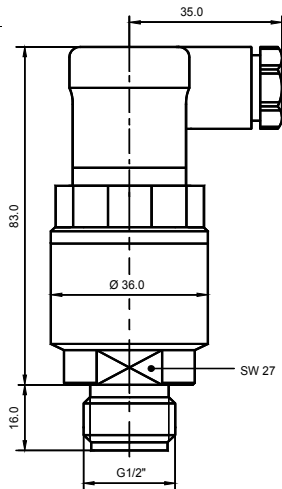

P115 Connector
EN175301-803A IP 67

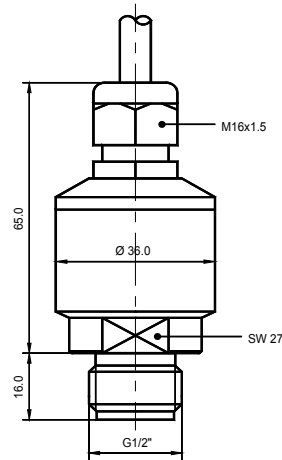

P115 Cable connection
IP 67

Electrical connections

**Connector
EN 175301-803A**

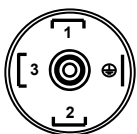

4...20 mA 2-wire
PIN1 Signal +
PIN2 Signal -

**Quickon-
Connector**



4...20 mA 2-wire
PIN1 Signal +
PIN2 Signal -

**Connector M12x1,
4-pin**

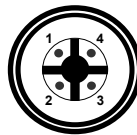

4...20 mA 2-wire
PIN1 Signal +
PIN3 Signal -

**Cable
connection**

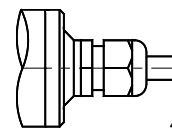

4...20 mA 2-wire
red Signal +
black Signal -

Modifications reserved without notice, 11.11