

- Process connection with ceramic sensor without oil filling
- Range from 100 mbar to 60 bar
- Accuracy $\leq 0,35\%$
- High overload capability
- Small, robust design IP 67
- Different process connections
- Analog output: 4...20 mA, 2-wire
0,5...4,5 V, 0...5 V, 0...10 V, 3-wire

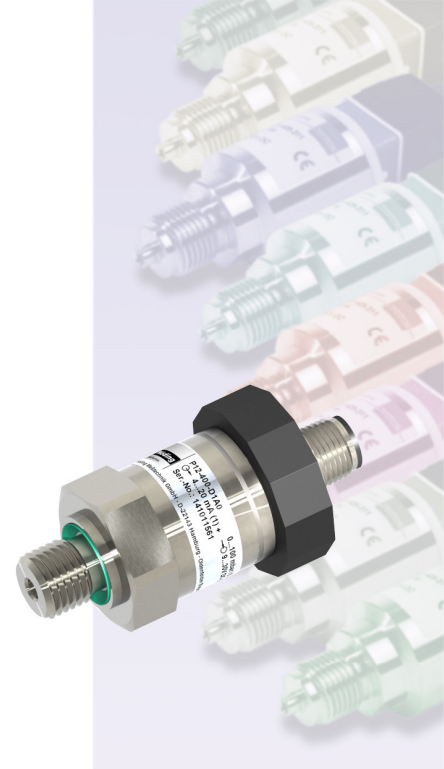

Pressure transmitter P 12

Technical data:

Range:	0...100 mbar to 0...60 bar
Output signal:	4...20 mA, 2-wire, 0,5...4,5 V, 0...5 V, 0...10 V, 3-wire
Accuracy:	$\leq \pm 0,35\%$ FS @ 25°C $\leq \pm 0,5\%$ FS < 0...200mbar
Time constant T_{90} :	200 ms
Supply voltage:	9...30V DC, 4...20 mA, 0...5 V, 0,5...4,5V output 5V DC, 0,5...4,5 V ratiometric 15...30V DC, 10V output
Ambient temperature:	-25...80 °C
Process temperature:	-25...100 °C
Temperature coeff.:	$\leq \pm 0,02\%$ FS/K (zero) $\leq \pm 0,03\%$ FS/K < 0...200mbar $\leq \pm 0,02\%$ FS/K (span)
Long term stability:	$\leq \pm 0,3\%$ FS p. a.
Housing:	Edelstahl 1.4404 (316L)
Sensor:	Ceramic AL ₂ O ₃ , Gold coated
Protection class:	IP 67 (IP68)
Weight:	ca. 0,12 kg

Nöding

Meßtechnik

Ranges

range	Ordering code	Overload (bar)	Burst load (bar)
0...100 mbar / 0...10 kPa *)	00	-1/2	4
0...160 mbar / 0...16 kPa *)	01	-1/2	4
0...200 mbar / 0...20 kPa	B1	-1/2	4
0...250 mbar / 0...25 kPa	02	-1/2	4
0...400 mbar / 0...40 kPa	03	-1/2	4
0...500 mbar / 0...50 kPa	B7	-1/4	8
0...600 mbar / 0...60 kPa	04	-1/4	8
0...1 bar / 0...100 kPa	05	-1/4	8
0...1.6 bar / 0...160 kPa	06	-1/7	13
0...2 bar / 0...200 kPa	B3	-1/7	13
0...2.5 bar / 0...250 kPa	07	-1/10	18
0...3 bar / 0...300 kPa	X3	-1/10	18
0...4 bar / 0...400 kPa	08	-1/10	18
0...5 bar / 0...500 kPa	F1	-1/21	25
0...6 bar / 0...600 kPa	09	-1/21	25
0...10 bar / 0...1 MPa	10	-1/30	50
0...10 bar / 0...1 MPa *)	HD	-1/105	175
0...16 bar / 0...1.6 MPa	11	-1/60	100
0...20 bar / 0...2 MPa	B5	-1/60	100
0...25 bar / 0...2.5 MPa	12	-1/105	175
0...40 bar / 0...4 MPa	13	-1/105	175
0...60 bar / 0...6 MPa	14	-1/210	350
-100...0 mbar / -10...0 kPa *)	C4	-1/2	4
-100...100 mbar / -10...10 kPa	C5	-1/2	4
-1...1 bar / -100...100 kPa	D6	-1/7	13
-1...3 bar / -100...300 kPa	D8	-1/21	25
-1...5 bar / -100...500 kPa	D9	-1/21	25
-1...9 bar / -100...900 kPa	E1	-1/30	50
-1...15 bar / -0,1...1,5 MPa	E2	-1/60	100
-1...19 bar / -0,1...1,9 MPa	E3	-1/60	100
-1...25 bar / -0,1...2,5 MPa	E7	-1/105	175

*) Accuracy 0,5%, Temperature coeff $\pm \pm 0,03\%$ FS/K (zero)

Other relativ- and absolut pressure ranges on request

(1) only at cable-version

Ordering code

Output signal

- 1 0...10 V 3-wire
- 4 4...20 mA 2-wire
- 8 0...5 V 3-wire
- A 0,5...4,5 V 3-wire, ratiometric
- B 0,5...4,5 V 3-wire, 9 – 30V Supply

Range

- Measurement range see table
- 99 non-standard range (on request)

Process connection and material

- D G 1/4" DIN 3852 1.4404
- 3 G 1/2 B DIN EN 837-1 1.4404
- G G 1/2" u. 11,6 mm drill hole
- 9 others (on request)

Sensor seal

- 1 FPM (Viton) Standard
- 2 NBR (Perbuan)
- 3 EPDM-Kautschuk
- 5 Chemraz 505
- 9 others (on request)

Electrical connection

- 0 5m PVC cable
- 1 Connector EN 175301-803A
- 6 2m PVC cable
- A Connector M12x1
- H 10m PVC cable
- R 25m PVC cable
- 9 others (on request)

Optionen

- 0 not potted
 - 1 potted electronic
 - 2 potted electronic IP 68 (1)
- (1 mWC/48h)

P12 - [] - [] - [] - [] - []

Dimensions (mm)

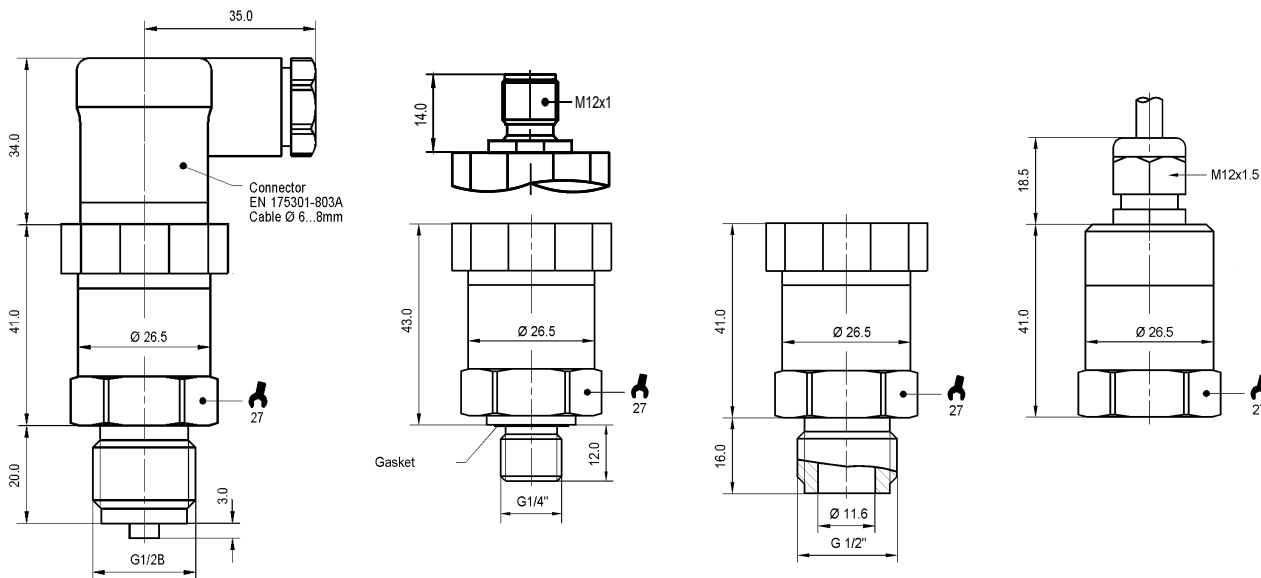

Electrical connections

Connector EN175301-803A

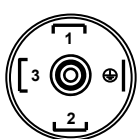

4...20 mA 2-wire
PIN1 Signal +
PIN2 Signal -

0...10V / 0...5V
0,5...4,5V 3-wire

PIN1 in +
PIN2 in -
PIN3 out +

Connector M12x1, 4-polig

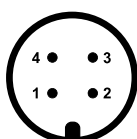

4...20 mA 2-wire
PIN1 (brown) Signal +
PIN3 (blue) Signal -

0...10V / 0...5V
0,5...4,5V 3-wire

PIN1 (brown) in +
PIN3 (blue) in -
PIN4 (black) out +

Cable connection

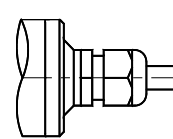

4...20 mA 2-wire
red Signal +
black Signal -

0...10V / 0...5V
0,5...4,5V 3-wire

red in +
black in -
white out +

Modifications reserved without notice 04.15